

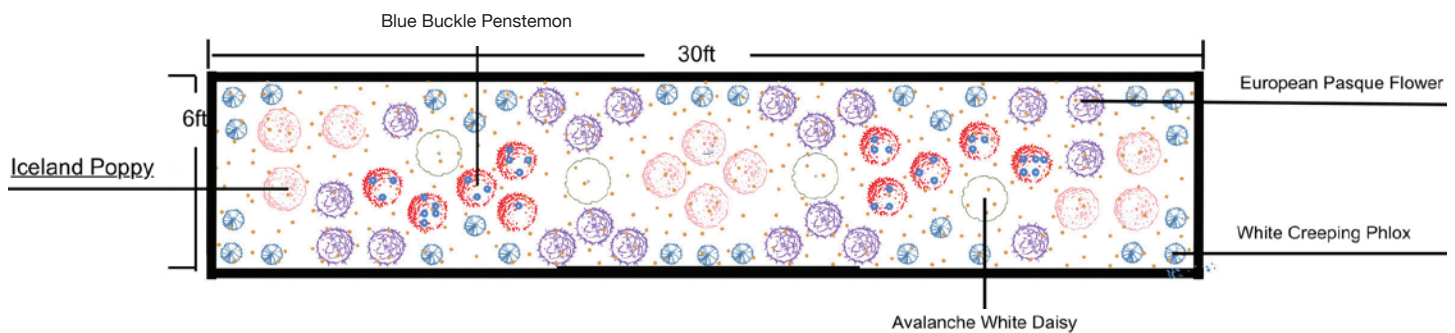

# Planting Plans for Your Garden

Turn your yard into a mountain oasis with 3 professionally designed planting plans suited to Summit County's high alpine environment.



## FULL SUN GARDEN

Plant this garden next to sunny sidewalks or driveways. Full sun plantings require more than 6 hours of sunlight daily.

### PLANT LIST

- (4) Avalanche White Daisy *Osteospermum 'Avalanche'*
- (10) Blue Buckle Penstemon *Penstemon virgatus 'Blue Buckle'*
- (10) Iceland Poppy *Papaver nudicaule*
- (20) European Pasque Flower *pulsatilla vulgaris*
- (30) White Creeping Phlox *Phlox subulate 'White Delight'*



## FULL SUN/PARTIAL SHADE GARDEN

Invite hummingbirds and butterflies to your yard. This garden works in full sun (6+ hours of direct sunlight) or partial shade (4-6 hours of direct sunlight).

### PLANT LIST

- (2) Blanket Flower *Gaillardia aristata*
- (5) Catmint *Nepeta x faassenii*
- (16) European Pasque Flower *Pulsatilla vulgaris*
- (3) Goldenrod *Solidago simplex var. simplex*
- (1) Serviceberry *Amelanchier alnifolia*
- (4) Yarrow *Achillea millefolium 'Colorado'*

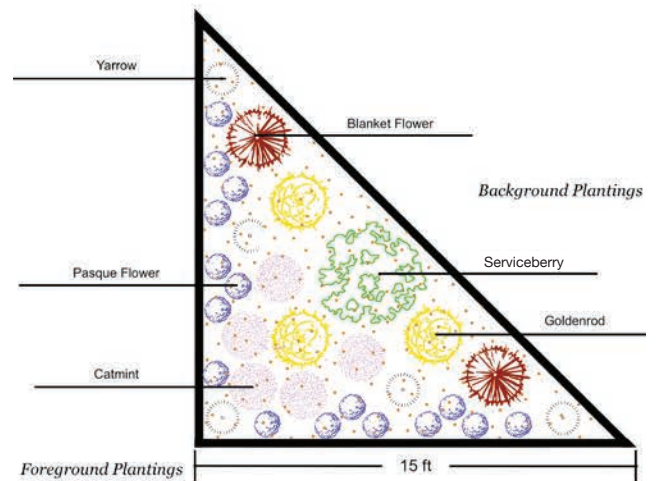

## SHADE/PART SHADE GARDEN

Create cool comfort in shady areas of your yard. This garden works in partial shade (4-6 hours of direct sunlight) or full shade (less than 4 hours of direct sunlight).

### PLANT LIST

- (6) Astilbe *Astilbe 'Spotlight'*
- (6) Blue Fescue Grass *Festuca glauca*
- (3) Ivory Halo Dogwood *Cornus alba 'Bailhalo'*
- (5) Glitter Coral Bells *Heuchera 'Glitter'*
- (3) Rocky Mountain Columbine *Aquilegia coerulea*
- (6-8) Sweet Woodruff *Galium Odorata*

